

**1. General**

1.1. Package: 2 x GH9 ( each filter consists of a pair of two matched packages GH9 )

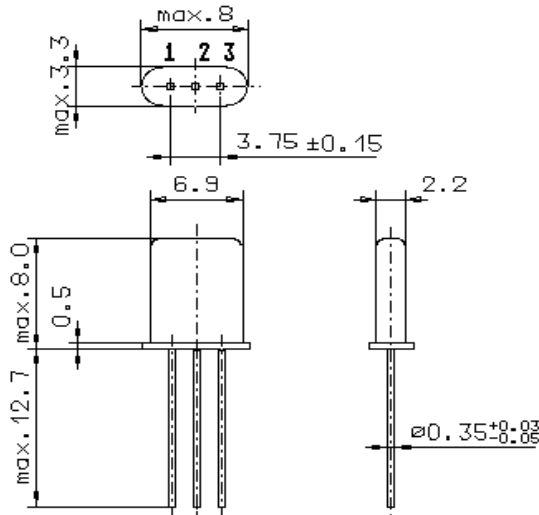

GH9

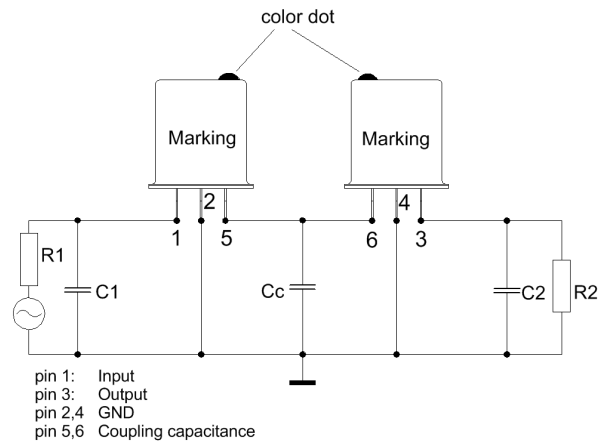

- |                                   |                  |
|-----------------------------------|------------------|
| 1.2. Type name:                   | MQF 21.4-1200/02 |
| 1.3. Number of poles:             | 4                |
| 1.4. Operable temperature range:  | -30°C to +80°C   |
| 1.5. Operating temperature range: | -25°C to +70°C   |
| 1.6. Storage temperature range:   | -55°C to +80°C   |

**2. Electric values**

- |   |   |
|---|---|
| 2.1. Nominal centre frequency fo:   | 21.4 MHz                                |
| 2.2. <b>Pass band</b>   |   |
| 2.2.1. Bandwidth between 3 dB - frequencies:                                | $\geq f_o \pm 6.0$ kHz                  |
| 2.2.2. Ripple:  | $\leq 1.0$ dB at $f_o \pm 4.5$ kHz      |
| 2.2.3. Insertion loss:<br>( measured on smallest attenuation in pass band ) | $\leq 2.0$ dB                           |
| 2.3. <b>Stop band</b>   |   |
| 2.3.1. $f_o \pm 20$ kHz   | $\geq 40$ dB                            |
| 2.3.2. $f_o + 50$ kHz.....+1000 kHz   | $\geq 65$ dB                            |
| 2.3.3. $f_o - 100$ kHz.....-1000 kHz  | $\geq 80$ dB                            |
| 2.3.4. Spurious responses:  | $\geq 40$ dB                            |
| 2.4. Terminating impedance R//C ( input and output ):                       | 1200 $\Omega$ // 2.5 pF                 |
| 2.4.1. Coupling capacitance Cc:   | 9.0 pF                                  |
| 3. Marking:   | manufacturer, date code<br>21.4-1200/02 |
| 4. Environment conditions:  | Corresponding to Vectron standard CF001 |