

Specification for monolithic crystal filter:

MQF 21.4-1200/10

1. General

1.1. package:

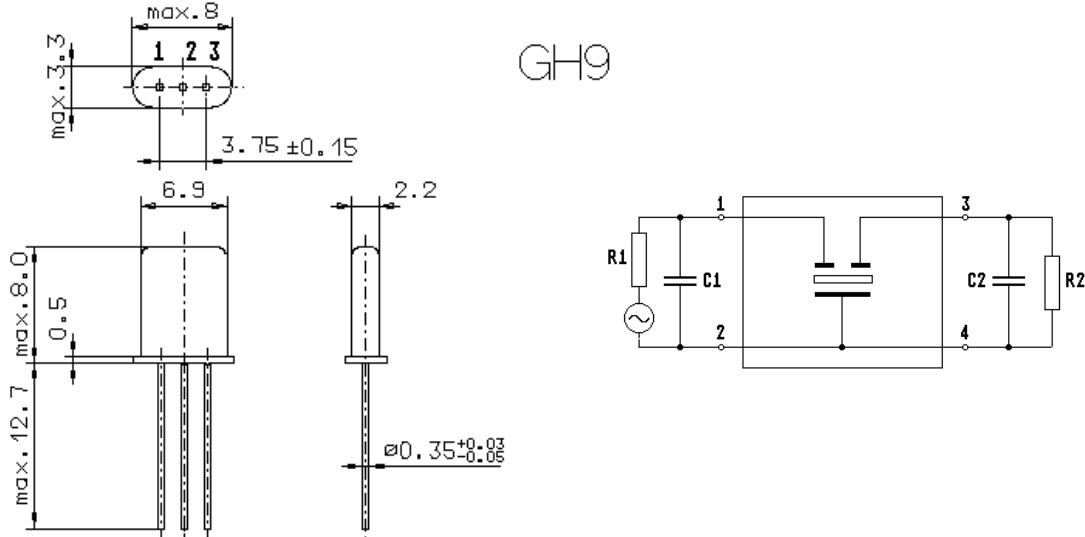

- 1.2. Type name: MQF 21.4-1200/10
- 1.3. Number of poles: 2
- 1.4. Operating temperature range: -40°C to +85°C
- 1.5. Storage temperature range: -55°C to +90°C

2. Electric values

- 2.1. Nominal centre frequency fo: 21.4 MHz

2.2. Pass band

- 2.2.1. Bandwidth between 3 dB - frequencies: $\geq f_0 \pm 6.0$ kHz
- 2.2.2. Ripple: ≤ 0.5 dB at $f_0 \pm 3.5$ kHz
- 2.2.3. Insertion loss: ≤ 1.5 dB
(measured on smallest attenuation in pass band)

2.3. Stop band

- 2.3.1. $f_0 \pm 25$ kHz ≥ 20 dB
- 2.3.2. $f_0 + 350$ kHz.....+ 1000 kHz ≥ 35 dB
- 2.3.3. $f_0 - 200$ kHz.....- 1000 kHz ≥ 50 dB

- 2.4. Terminating impedance R//C (input and output): $1200 \Omega // 3.0$ pF

- 3. Marking: manufacturer, date code
21.4-1200/10

- 4. Environment conditions: Corresponding Vectron MIL standard

Edited by: _____ date: _____ name: _____